



## Memorandum

**Date:** November 16, 2015

**From:** Marc R. Acampora, PE

**Subject:** Trip Generation Study for Proposed Webb Bridge Windward Tract  
City of Alpharetta, Fulton County, Georgia

The anticipated trip generation was calculated for a proposed single family residential development in the City of Alpharetta. The proposed Webb Bridge Windward Tract will consist of 45 single family homes to be located along the north side of Webb Bridge Road as shown in Figure 1. The site plan for the proposed development is shown in Figure 2.

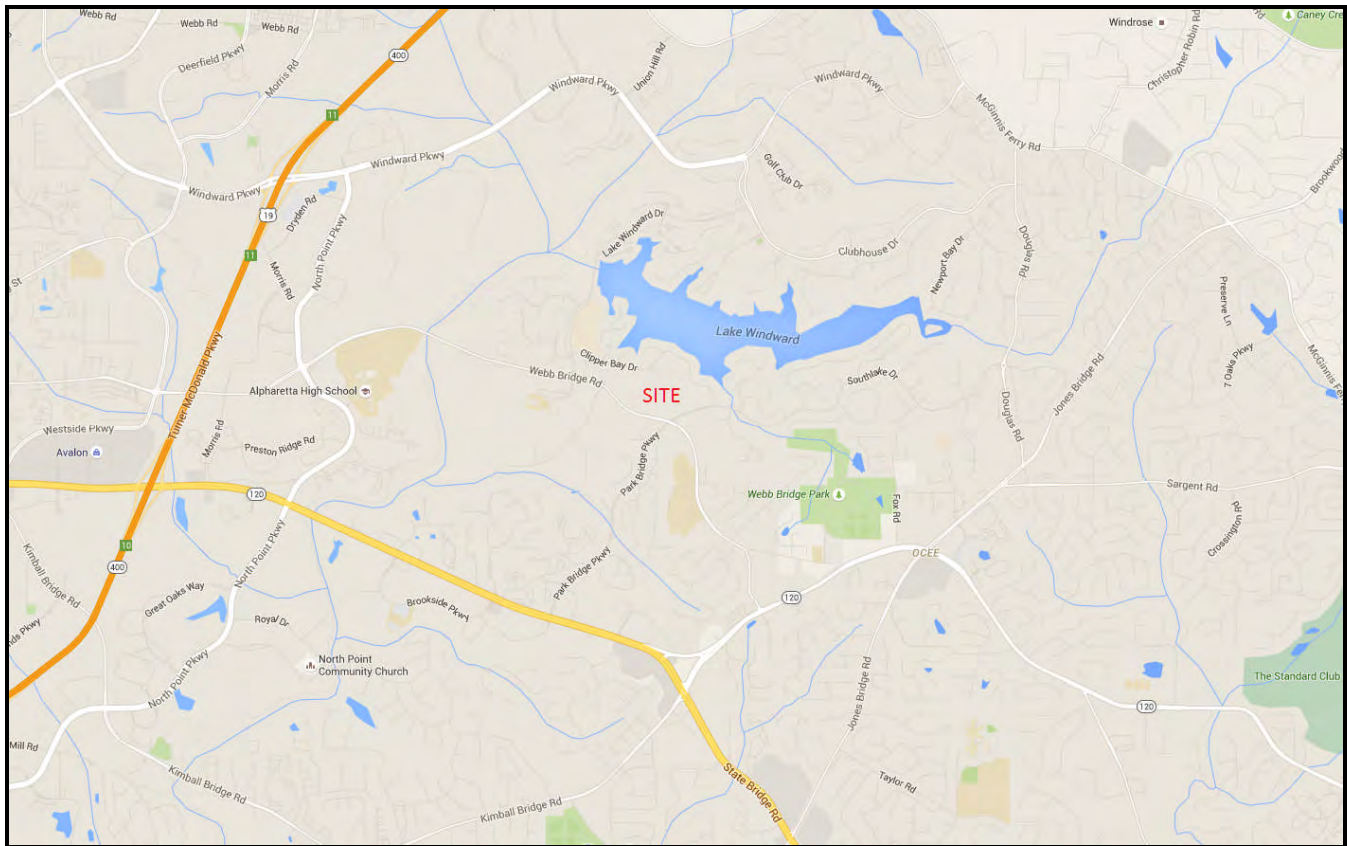

Figure 1 – Webb Bridge Tract Location Map

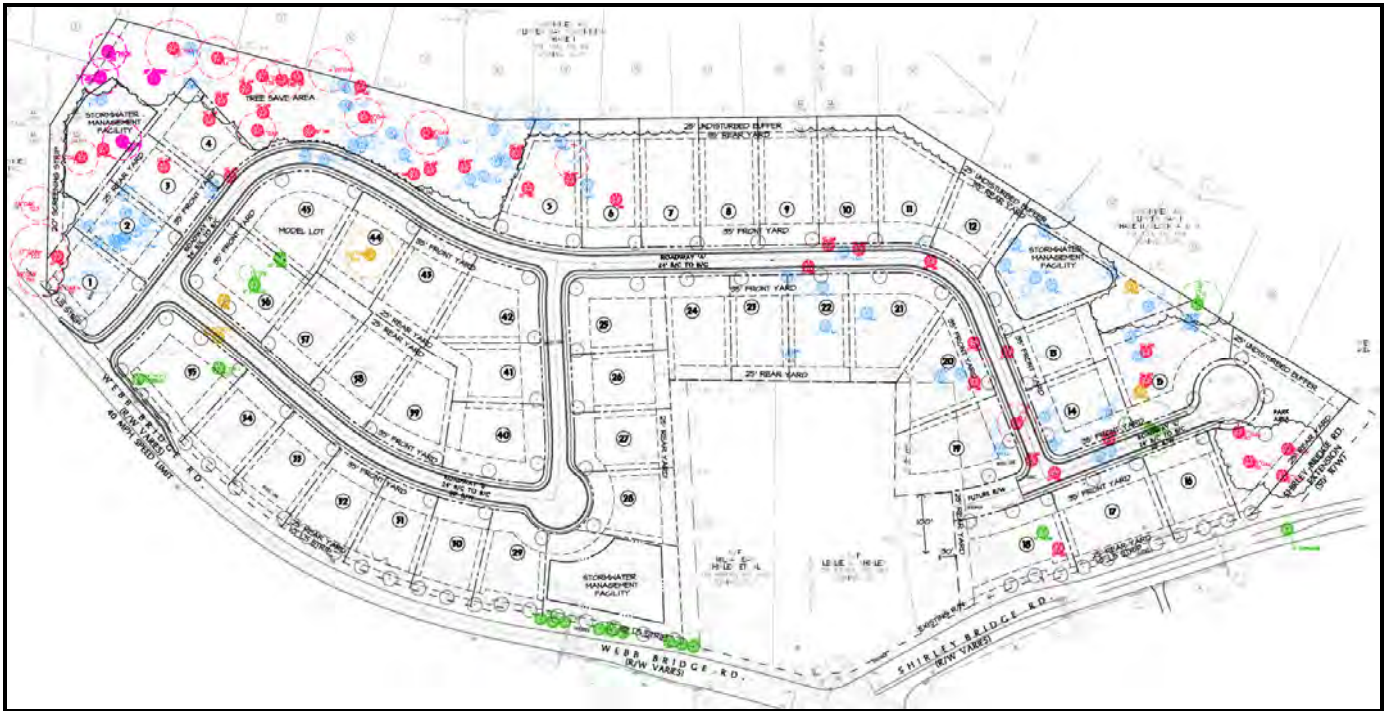

Figure 2 – Webb Bridge Tract Site Plan

The volume of traffic that will be generated by the proposed development was calculated using the equations in the Institute of Transportation Engineers (ITE) *Trip Generation Manual*, 9<sup>th</sup> Edition. This document is the traffic engineering industry standard to determine the volume of traffic that a development will generate. Its data is based on traffic counts collected at similar facilities nationwide. The trip generation for the Webb Bridge subdivision was calculated using ITE Land Use 210 – Single-Family Detached Housing and is shown in Table 1.

Table 1 – Webb Bridge Windward Tract Trip Generation

Land Use	ITE Code	Size	A.M. Peak Hour			P.M. Peak Hour			24-Hour 2-Way
			In	Out	Total	In	Out	Total	
Single Family	210	45 homes	10	31	41	32	19	51	504